

# VL9 Visu-Link Installation Data Sheet

Suggested Tools:  
 electric Drill  
 3/16" carbide masonry drill  
 screw driver  
 wire stripper  
 cable stripper  
 wire cutters  
 terminal crimping tool

Materials Required:  
 appropriate fasteners  
 caulking compound

Misc. parts provided  
 3 wire terminals  
 1 cap screw

## Installation

The Visu-Link electronics and battery are environmentally sealed and suitable for outdoor installation, the wire terminals are not sealed for moisture. The unit should not be installed in locations below grade or in a submersible environment.

1. Using the VL9 base as a template, locate and mark mounting holes on outside wall of building. For best results the VL9 should be located at eye level in an easily accessible location.

2. Remove VL9 cover.

3. Secure VL9 base to wall using the mounting dimensions in the drawing shown to drill the locating holes.

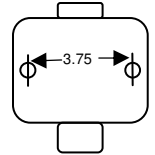

4. Run the cable from the meter to the VL9. Cable per UL 2464 24 gauge 7/32, with foil shield and drain.  
 Note: Never place the cable in a conduit with conductors carrying A/C.

5. Attach cable to meter and to VL9, be sure to follow the connecting schematic. Be sure connections are secure and protected.

6. Tap VL9 to test installation, the meter reading and serial number will be displayed. You may also see one of the following error messages;

error	remedy
"no response"	check connections, check diagram
"unknown register"	be sure you are using a supported register
"framing error"	corrupted data , check connections
"parity error"	check cable connections

7. Comply with all the necessary ordinances and codes.

8. Caution when drilling holes in walls, there may be electricals inside. Wear safety glasses. Secure and clean all debris from the install.

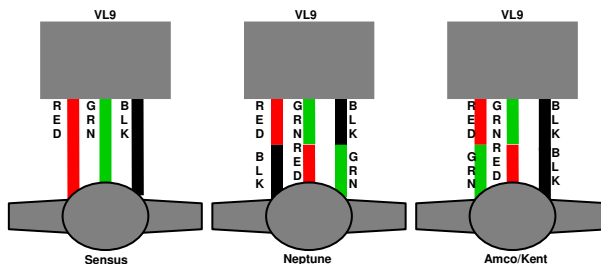

**Kemp-Meek MFG. INC.**  
 101 Park Central  
 Mineola, TX 75773  
 903.569.9700  
[www.kempmeek.com](http://www.kempmeek.com)