



MovinCool® Climate Pro® K Series

MovinCool Climate Pro K63



FAMILY FEATURES

- Sleek, modern design
- Wrap around bumper system protects against scratches & dents
- Built-in exhaust flanges with protective grille
- Condensate tank hidden behind easy-open access door
- Convenient cord storage cubby on rear of unit
- Connectivity enabled

PERFORMANCE

Ambient Operating Range	65-105 °F
Cooling Capacity	60,000 btu/h
Supply Airflow h/m/l cfm	1770/1710/1650
Max Supply/Cold Duct Length	40 feet
Exhaust Airflow h/m/l cfm	2400 (h)
Max Hot/Exhaust Duct Length	100 feet
Sound Level High (w/out duct)	71 dB

APPLICATION

Voltage @ 60Hz	460
Recommended Breaker Size (A)	20
Amps (A)	12
Min/Max Voltage	440-480
Power Cord Gauge	12AWG-3 Core
Power Cord Length	6 feet
Plug Receptacle Requirement 	NEMA L16-20

SHIPPING/LOGISTICS/ HANDLING/QUALITY

	Shipping	Out of Carton
Weight (lbs.)	734	642
Height (in.)	69	64
Width (in.)	34	31
Depth (in.)	59	55

RoHS Restriction of Hazardous Substances Standard compliant
UL 60335 and UL 60335-2-40 compliant

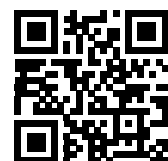

spot-coolers.com
800-367-8675

© 2020 Spot Coolers

ACCESSORIES

NOZZLE APPLICATION

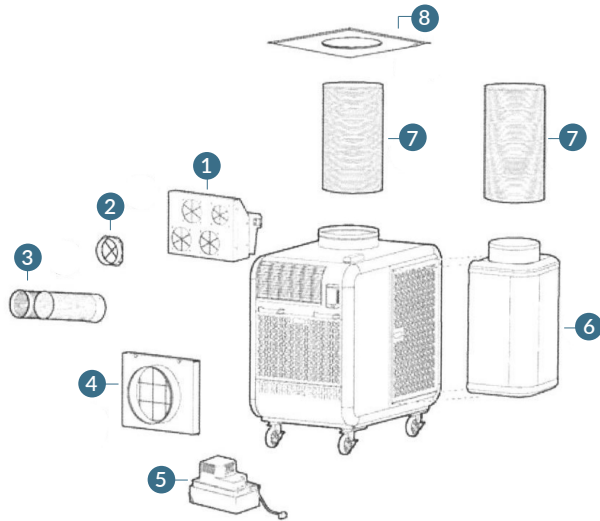

#	Part No.	Description
1	481769-0290	6" Base, Four Hole
2	481170-0490	6" Quick Connect Flange**
3	484209-0490	6" Nozzle**
4	484350-1330	Plenum Evaporator Air
5	484789-0240	Condensate Pump Kit, 230v
6	484350-1230	Plenum Condenser Air
7	LAY45820-0010	Flexible Air Duct, 8' by 16"
8	484490-1040	Ceiling Tile Kit, 16-in hole, metal
*	HDK-16	2' x 2' Ceiling Tile with 7' of 16" Flex Duct

* Not Pictured

** Sold Individually

DUCT HOSE APPLICATION

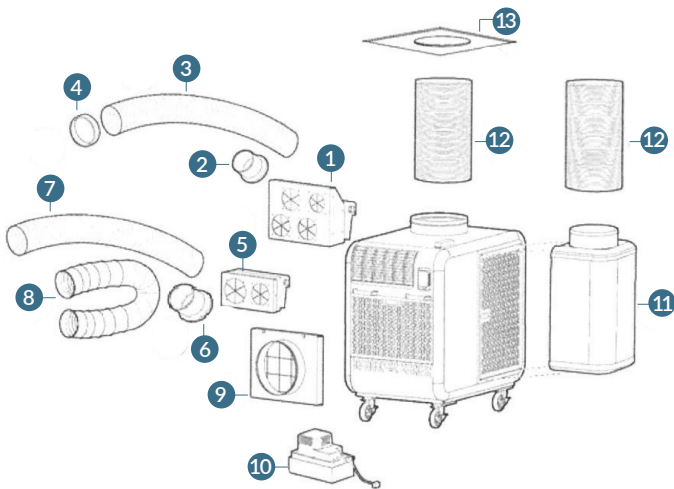

#	Part No.	Description
1	481769-0290	6" Base, Four Hole
2	481170-0460	6" Flange Ext. Duct
3	481744-0030	6" Self-Supported Duct**
4	481851-0210	6" Trim Ring**
5	481769-0300	8" Base, Two Hole
6	481170-0470	8" Flange Ext. Duct
7	LAY45810-0080	8" Self-Supported Duct**
8	LAY45810-0030	8" Flexible Air Duct**
9	484350-1330	Plenum Evaporator Air
10	484789-0240	Condensate Pump Kit, 230v
11	484350-1230	Plenum Condenser Air
12	LAY45820-0010	Flexible Air Duct, 8' by 16"
13	484490-1040	Ceiling Tile Kit, 16-in hole, metal
*	HDK-16	2' x 2' Ceiling Tile with 7' of 16" Flex Duct

* Not Pictured

** Sold Individually