

NOTES:

1. Refer to the condensate management and drain hose plumbing for different configurations in this document. No hose clamps are needed for the condensate pan hook up.
2. Drip leg in the gas line must be installed.
3. The furnace controls require correct polarity on the power supply 24V secondary, and a proper ground.
4. Y & G must be connected to the control board for cooling operation.
5. Measure the supply air static pressure. Record this positive number. Measure the return air static pressure. Record this negative number. Treat the negative number as a positive, and add the two numbers together. This is total system static. If a filter rack is installed on the return air end of the furnace, the return air duct static must be measured between the filter and the blower.
6. Inlet gas pressure for natural gas should be 7" and that for propane should be 11" w.c. Nominal manifold gas pressure is 3.5" for natural gas and 10" w.c. for propane at high fire and 1.6" for Natural gas and 4.0" for Propane on low fire.
7. If thermoplastic indoor coil drain pans are to be installed in the up-flow/horizontal configuration, then extra 2" minimum spacing may be needed to ensure against drain pan distortion.
8. External filters required on all configurations.
9. Electrical entry is available on both sides of the casing.
10. All 33", 96% furnaces are approved for single-pipe and 2-pipe systems. For single pipe systems it is recommended to install the combustion air coupling provided and install approximately 18" of PVC pipe on the furnace.
11. Do not install an external condensate trap on these furnaces, as it will prevent the unit from operating correctly.

Models	Airflow CFM (Bottom Return without Filters)				Minimum Wire Size awg @ 75' One-Way	Maximum Over Current Protection
	0.5" ESP (Nominal) ¹					
	Low	Med-Lo	Med-Hi	High		
TM9Y040A10MP11	620	770	1040	1100	14	15
TM9Y060B12MP11	650	875	1150	1299	14	15
TM9Y080B12MP11	689	894	1182	1339	14	15
TM9Y080C16MP11	457	988	1404	1558	14	15
TM9Y100C16MP11	464	1015	1414	1570	14	15
TM9Y100C20MP11	660	1170	1629	1989	14	15
TM9Y120D20MP11	671	1189	1659	2036	14	15

Models	Input Rate		Total Unit Amps	Air Temp. Rise Max Input °F	Air Temp. Rise Min Input °F	Time For 1 ft ³ Natural Gas (1030 Btu/Ft ³) Seconds (On Max. Rate)
	Max	Min				
TM9Y040A10MP11	40,000	26,000	9.5	25-55	25-55	92
TM9Y060B12MP11	60,000	39,000	9.5	35-65	35-65	62
TM9Y080B12MP11	80,000	52,000	9.5	45-75	35-65	46
TM9Y080C16MP11	80,000	52,000	9.5	40-70	25-55	46
TM9Y100C16MP11	100,000	65,000	9.5	50-80	30-60	37
TM9Y100C20MP11	100,000	65,000	10.9	45-75	30-60	37
TM9Y120D20MP11	120,000	78,000	10.9	50-80	45-75	31

1. Other airflows are available. see tech guide for all CFM options.

LED INDICATOR

Indication	Condition
Slow Green Flash	Normal operation in standby mode.
Slow Amber Flash	Normal operation with call for heating
Fast Amber Flash	Low flame current with call for heat.
Any Red Flash	Fault condition.
4 Amber Flash	Call for cooling without a call for blower operation.

Subject to change without notice. Published in U.S.A. Copyright © 2015 by Johnson Controls, Inc. All rights reserved.

5052612-URG-A-0815 Supersedes: Nothing

York International Corp.
5005 York Drive
Norman, OK 73069

QUICK REFERENCE GUIDE

96% TWO STAGE STANDARD ECM MULTI-POSITION RESIDENTIAL GAS FURNACES

This document does not replace the installation instructions, which must be referred to for detailed information.

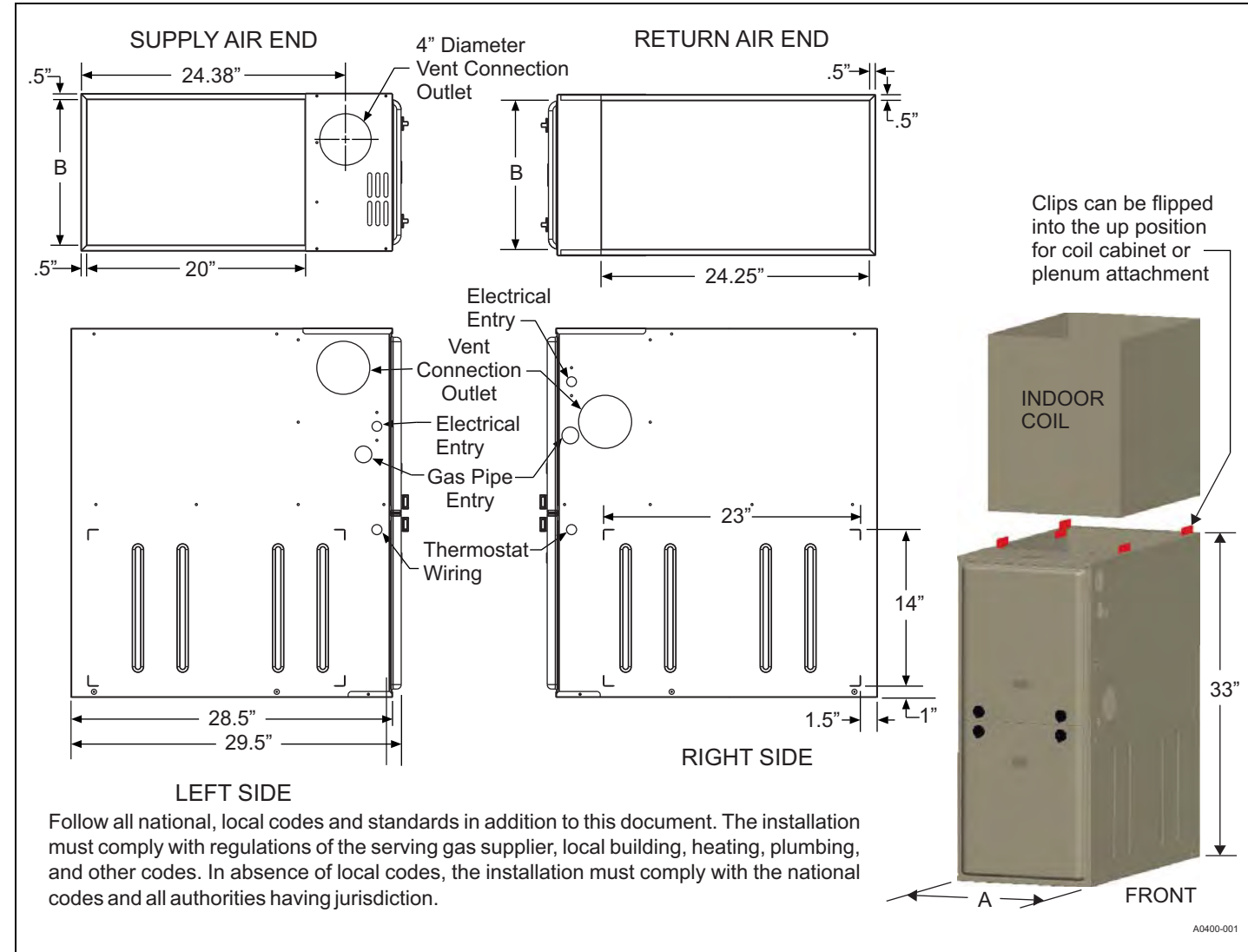

DIMENSIONS:	Cabinet Size		A (in)	B (in)
	All 'A' Cabinet Furnaces		14-1/2"	13-3/8"
	All 'B' Cabinet Furnaces		17-1/2"	16-3/8"
	All 'C' Cabinet Furnaces		21"	19-7/8"
	All 'D' Cabinet Furnaces		24-1/2"	23-3/8"

CLEARANCES: All furnaces approved for alcove and attic installation.

Application	Upflow	Downflow	Horizontal
Top	1"	0"	0"
Vent	0"	0"	0"
Rear	0"	0"	0"
Side	0"	0"	1"
Front ¹	0"	0"	0"
Floor	Combustible	Combustible ²	Combustible
Closet	Yes	Yes	Yes
Line Contact	No	No	Yes

1. 24" clearance in front and 18" on side recommended for service access.
2. For combustible floors only when used with combustible floor base accessory.

MOST COMMON INSTALLATION CONFIGURATIONS (MORE OPTIONS AVAILABLE WITH INDUCER ROTATION, WHICH IS COVERED IN THE INSTALLATION MANUAL)

MULTI-POSITION CONFIGURATION INFORMATION:

Ensure that all PVC venting has at least 1/4" per foot slope towards the furnace. Furnace is multi-position and may be installed in any of the configurations shown.

The furnace condensate pan is self priming and contains an internal trap.

Do not install an external condensate trap.

When drain hose routing changes are required (shown in red), be sure to cap all unused openings.

If rerouting hoses - excess length should be cut off so that no sagging loops will collect and hold condensate, which will cause the furnace to not operate.

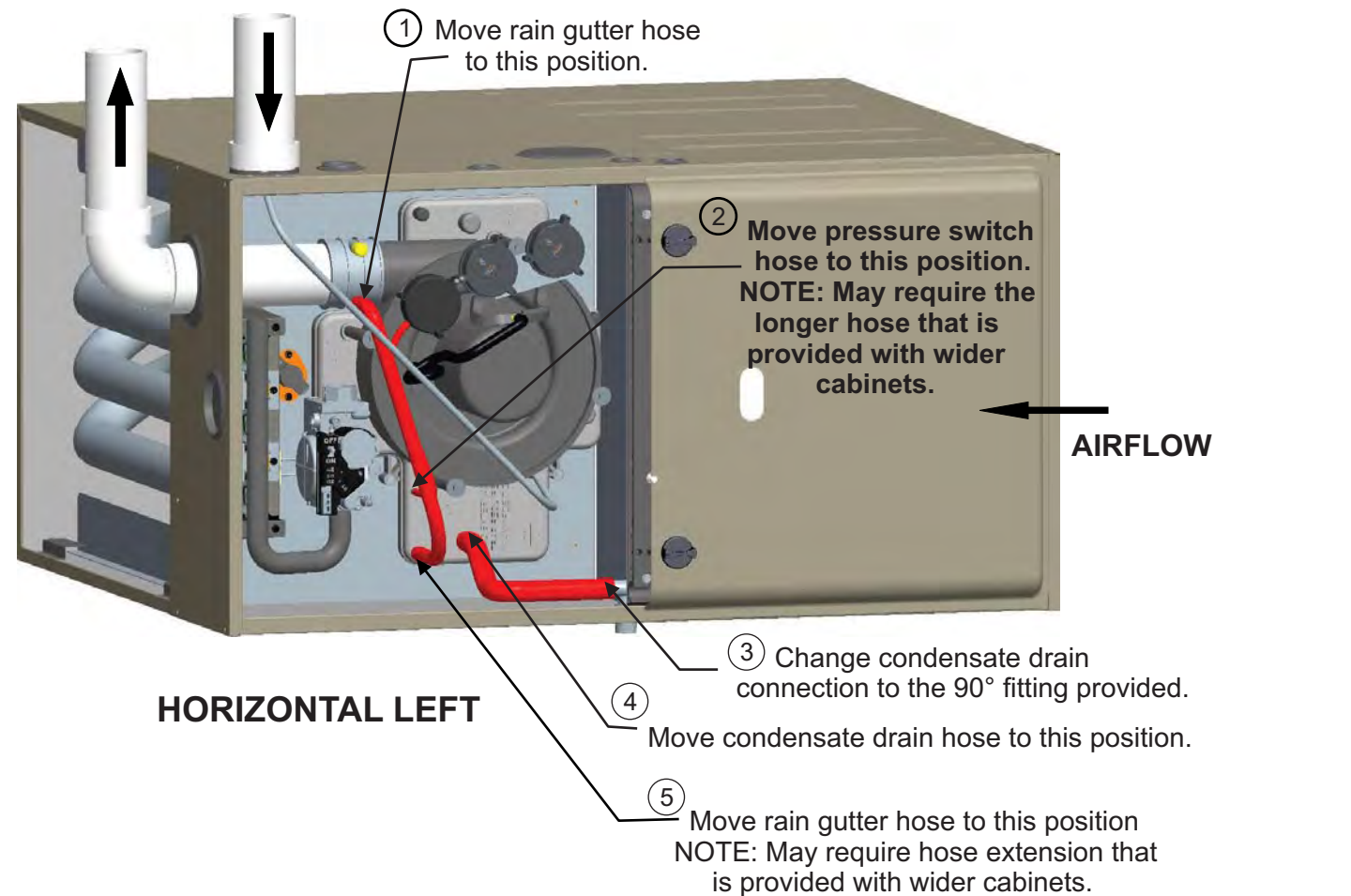
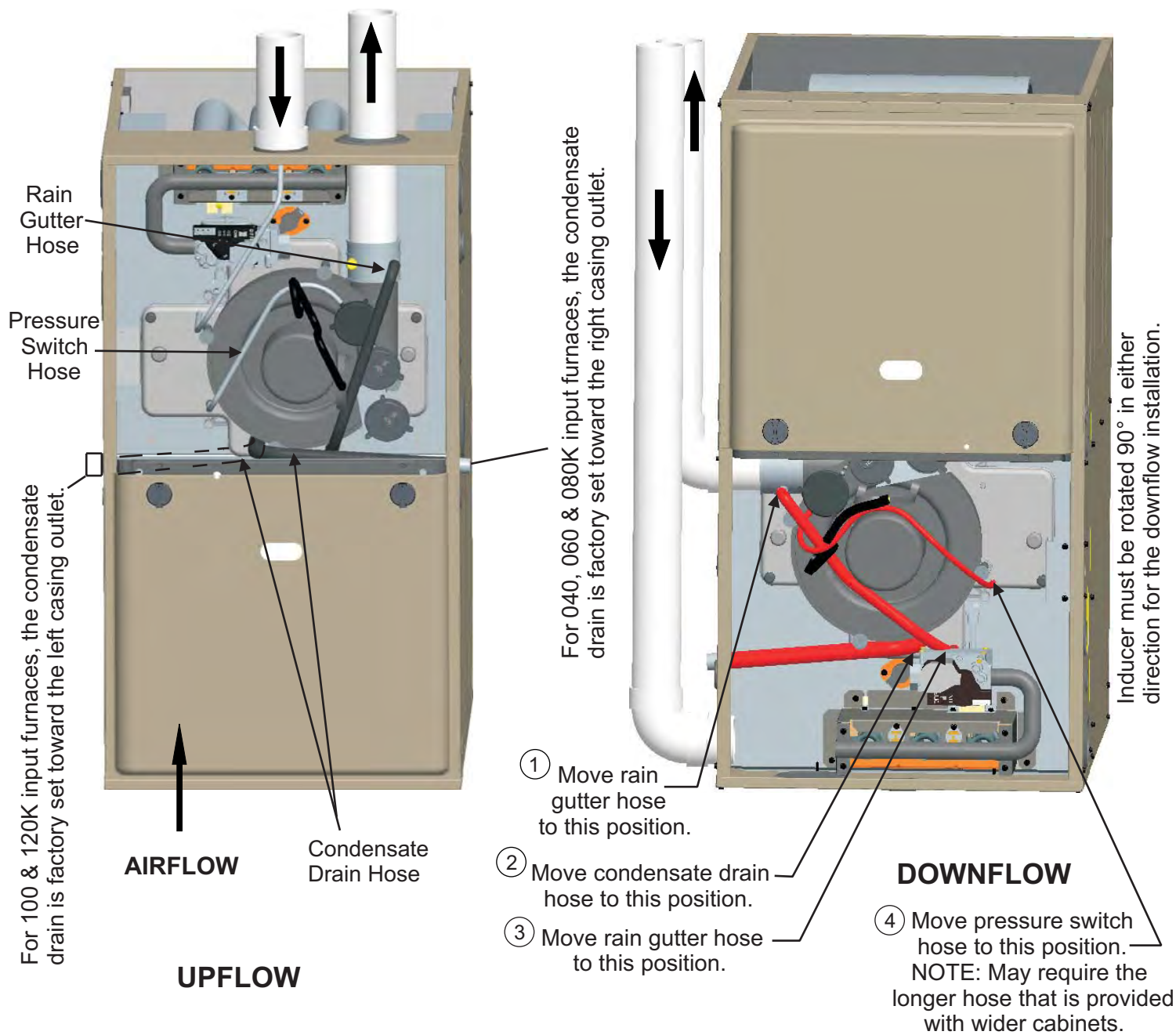

In upflow and downflow installation - Condensate drain hose may go out either side.