

AprilAire®

Ventilation

SUBMITTAL SHEET

Model 8142A

Fresh Air Ventilator with Backdraft Damper, No Filter

Project: _____

Dealer: _____

Architect: _____

Engineer: _____

Contractor: _____

Location: _____

Suppliers: _____

Date: _____



GENERAL DESCRIPTION

Model 8142A designed to bring in precisely the right amount of outdoor air into tight homes and complies with ASHRAE Standard 62.2.

Optimizes energy savings by locking out ventilation during hottest/coldest times of the day. Built in control automatically compensates for the ventilation time that is missed by bringing in additional fresh outdoor air when temperatures are more moderate, improving IAQ.

- Motor 65 watts; 0.56 amps (FLA) @ 115v/LPH/60Hz
- Control ensures that ventilation occurs no less than one hour of every four hours
- Integrated control and backdraft damper
- Control provides the capability to adjust the High/low temperature limits
- 6-foot power cord with a standard 5-15P plug provided with unit
- 24-volt wiring to HVAC system. Furnace or air handler does not require an ECM motor to be an energy star home
- Removable, washable filter
- For indoor use only; Installation temperature up to 160°F
- Duct collars accept 6" duct
- Housing 22 gauge G60 sheet metal
- ETL listed

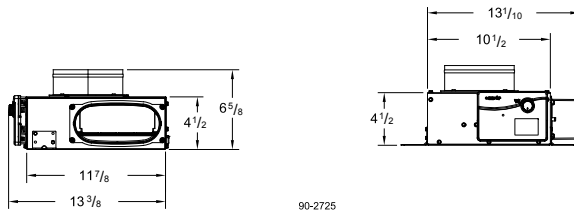
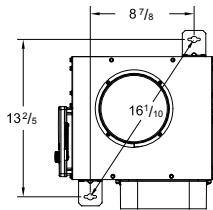
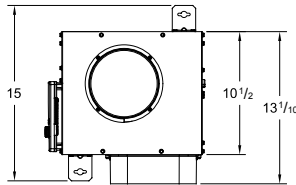

90-2725

When properly installed and set, it will meet the following mechanical ventilation requirements:

- International Energy Conservation Code (IECC) for fan efficacy
- ASHRAE 62.2
- Energy Star Certified Homes, Version 3
- EPA Indoor airPLUS, Version 1
- International Residential Code (IRC)
- California Energy Commission Title 24

The submittal is intended to show general, overall product dimensions and provide guidance for installation clearance. Drawings are not to scale. Ensure submittals are current. AprilAire reserves the rights to make product change without notifications or obligations.

PERFORMANCE				
External Static Pressure* ("w.c.)	0.0	0.2	0.4	0.6
Airflow (CFM)	245	220	190	160
Current (amps)	.63	.64	.64	.63
Efficacy (CFM/watt)	3.30	2.96	2.57	2.12

* Measured across ventilator.